

SCIENCE



HOW WE PLAY

Banks

- A) You can jump on the banks.
- B) You play the pirates on the banks.
- C) You can run around the banks.



SCIENCE!



HOW WE PLAY

Trees

- 1) You can't play with a brick or ball on the branches.
- 2) You can't run against the trees.
- 3) You can climb the tree.

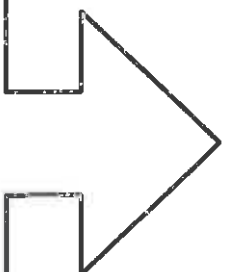
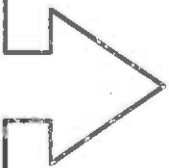

SCIENCE!

HOW WE PLAY



BIG SWING

1. You can moving
2. You can jump with the big swing is high.
3. You can play slide
- 4 You can lay the swing

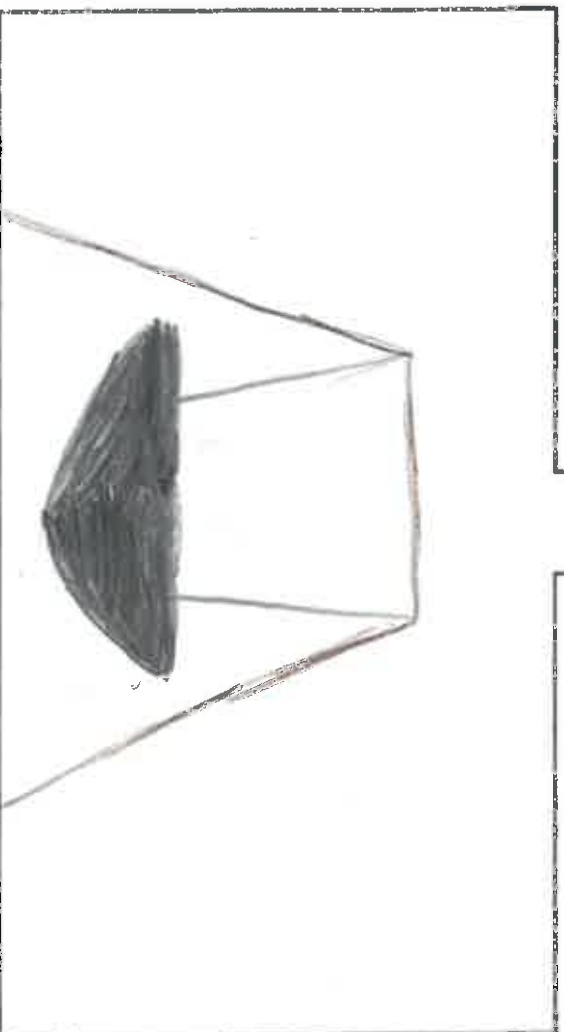

NAME: Dessa, Pau ; MATI'S DATE: Thursday, 6th of

May of 2021

SCIENCE



HOW WE PLAY SMALL SWING

1. Small swings
2. You can swing
3. You can take the swings and turn it.
4. You can't flip swings with the seat

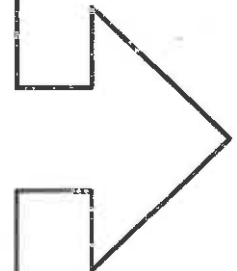
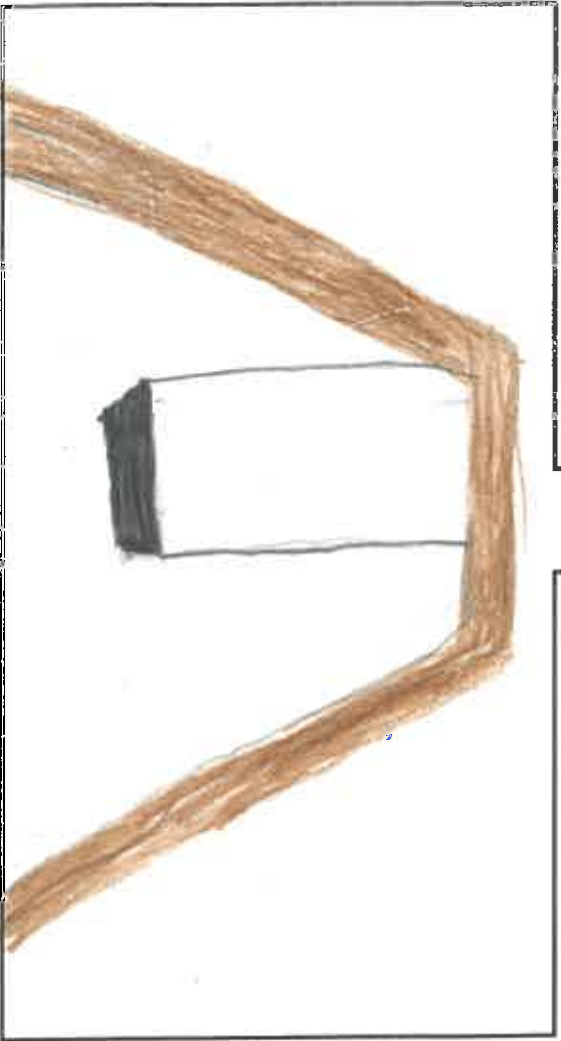
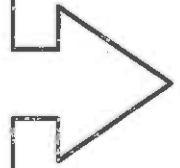

SCIENCE

HOW WE PLAY



Climbing wall

- It is to climb
- It is to hide
- Imagine that the climbing wall is a net and pass a ball to the other side

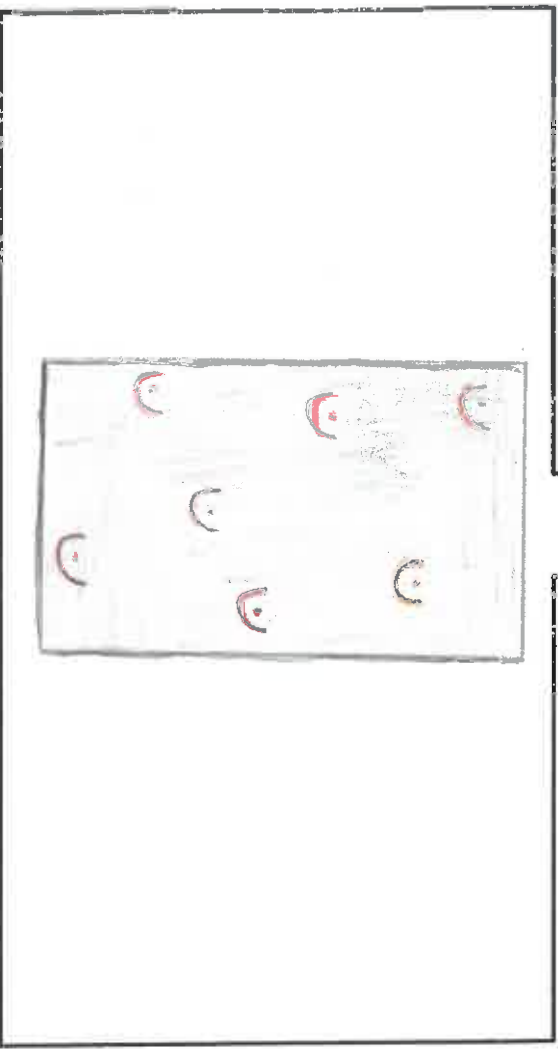

SCIENCE!

HOW WE PLAY

Water fountain

- It is to water our
- Throw water to each other
- Drink water
- Take the water
- Fill the water

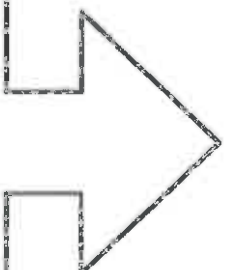
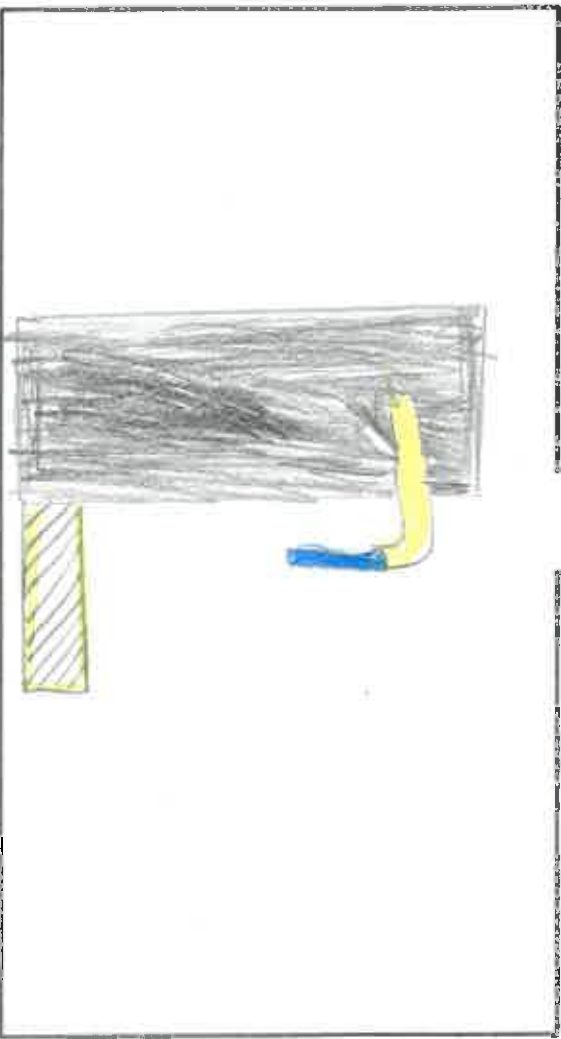
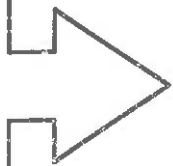

SCIENCE



HOW WE PLAY

PING-PONG TABLE

- we play table
- we play ping-pong
- you can: in game that, the table is a ping-pong table
- The ping-pong table is a table
- you can hide under the table
- you can play to jump on the ping-pong table

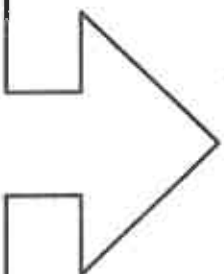
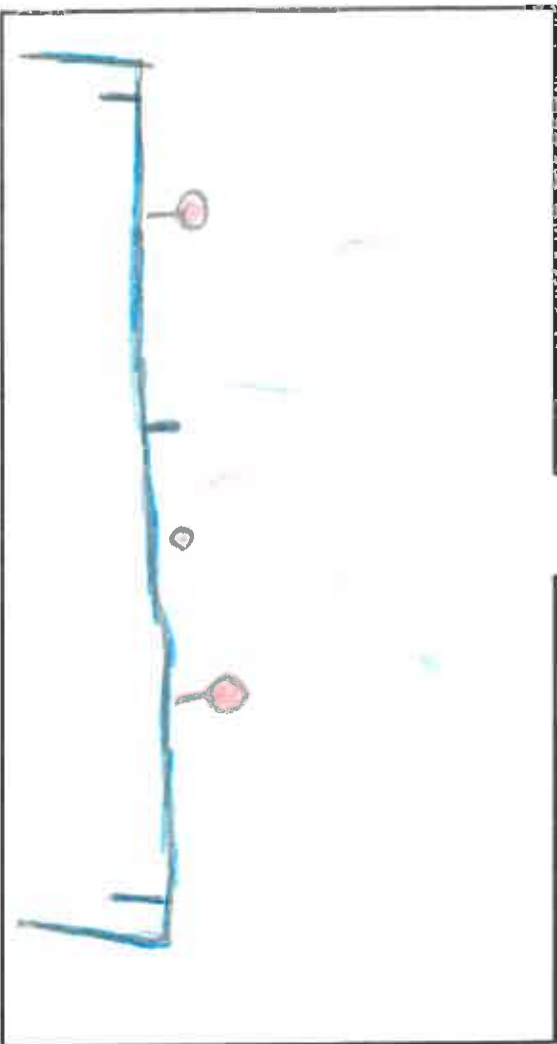
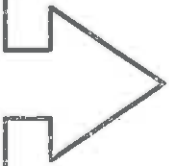

SCIENCE:



HOW WE PLAY

Big house!

- In the big house you can climb the iron bag
- Rest on the net
- Draw yourself on the slide.
- There is a part of the big house where you can jump around.
- There is a part of the big house where you can play the imagine that is your home.

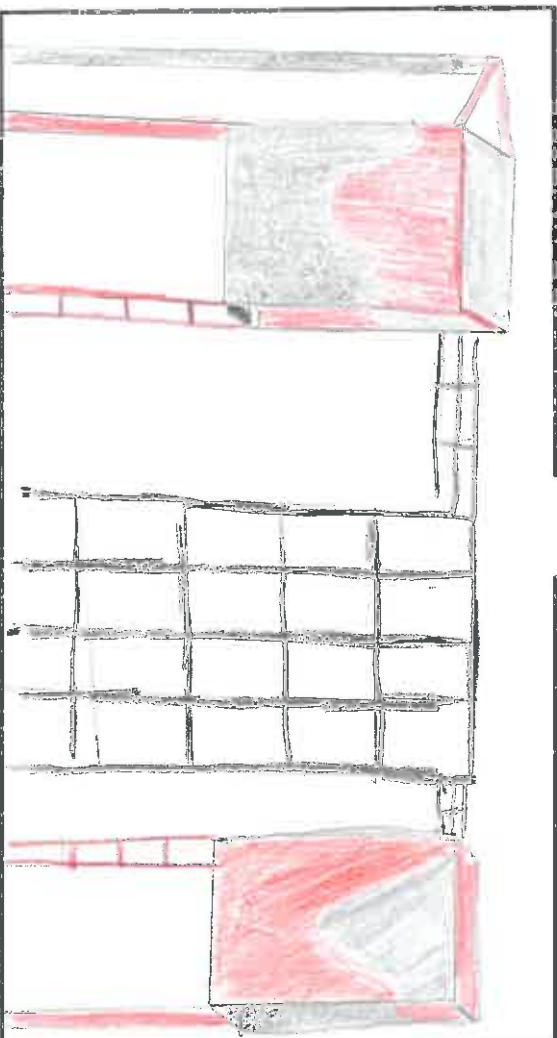
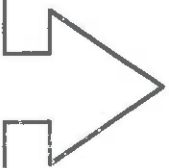

SCIENCE!



HOW WE PLAY

Sand box

- Do sand, water
- I imagine that you are making with the sand
- 3 Do a volcano of sand
- 4 Do Shapes in the sand
- 5 Do rivers with the water in the sand
- 6 Do balls in the sand
- 7 Draw in the sand
- 8. Make the hands in the sand.
- 9. Draw stars of sand

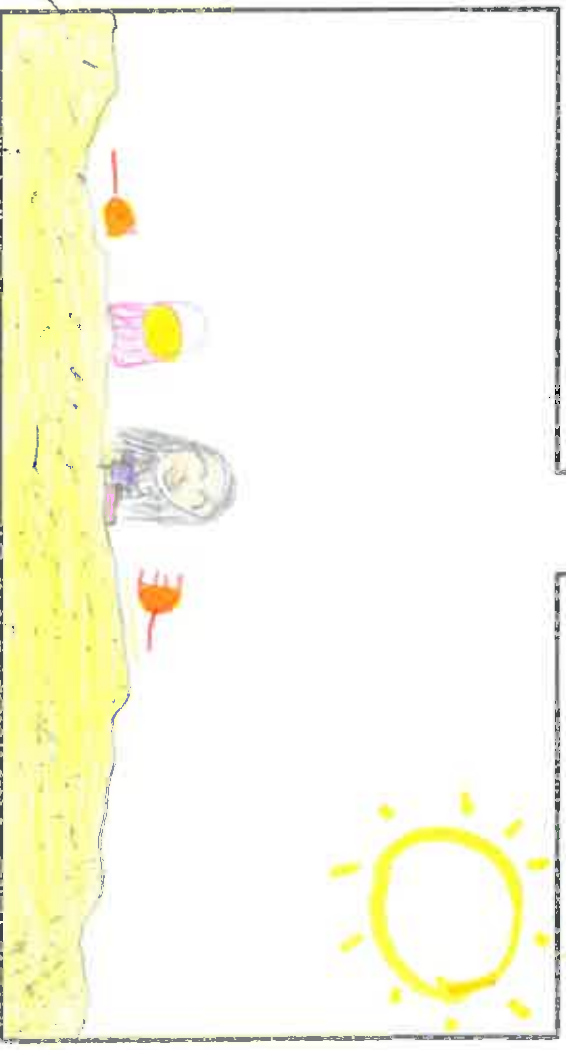

SCIENCE



HOW WE PLAY

SLIDE

- Throw yourself on the slide.
- Climb the ramp and let your go.
- Play to enjoy as that is what is meant.
- Play to imagine the water fall
- Play to imagine that is secret under the ground.

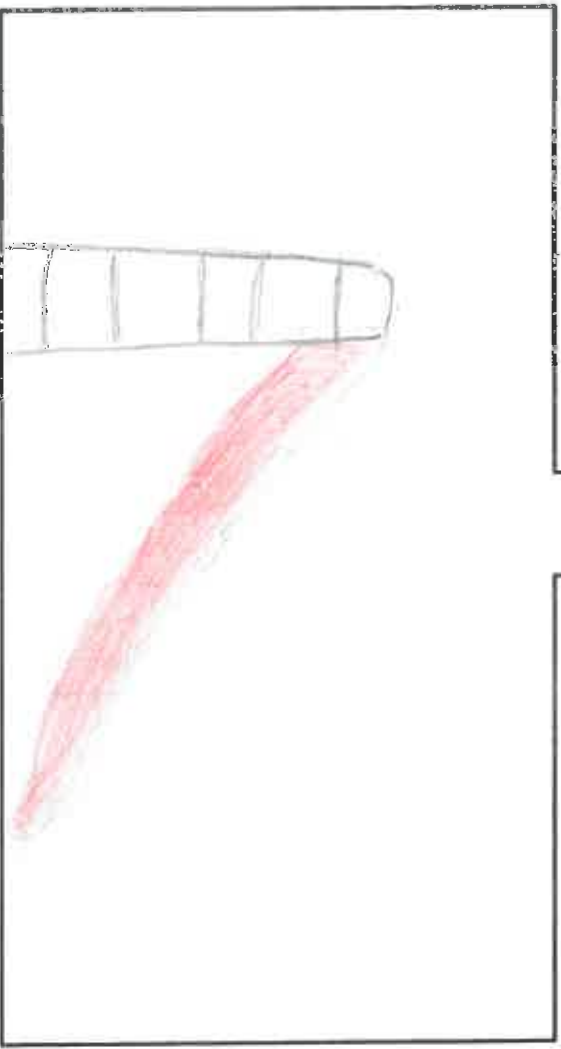

SCIENCE!

HOW WE PLAY



Small House

- Climb The Small House
- Play the water
- The password: if you don't have the Pass word you can't enter.
- throw yourself on the slide.

- Draw in the sand.

