

Our product is a system which control most of the power and temperature in the house. When you leave a room the power turns of and when you enter another room the power turns on in the that room. And when you leave the house all the that needs to be turned of turns of and the temperature is lowered.

We have 3 packs of product they all are including service and setup

The small pack:

The small pack includes one sensor the house, so u can't control each individual room but the whole house. This pack works best in smallere houses.

The medium pack:

The medium pack includes two sensor so you can separated the house into two parts and control each individual parts. This pack works best in small houses with for example two rooms.

The big pack:

the big pack includes sensor to each room in the house, so you have full control over the house. Because the big pack includes a app so you can control the house when you are not in it.

Contacts us for price and info.

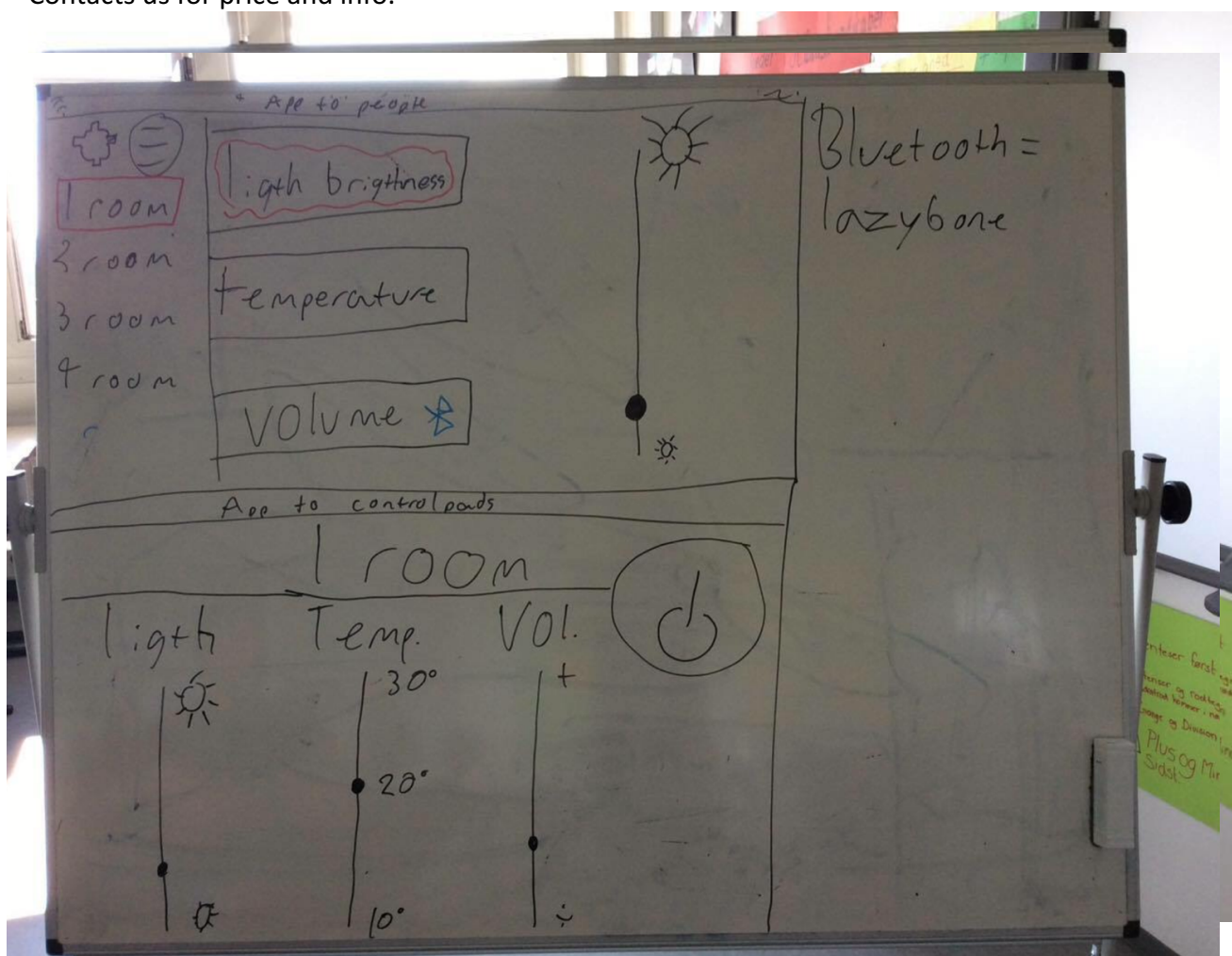

# I house

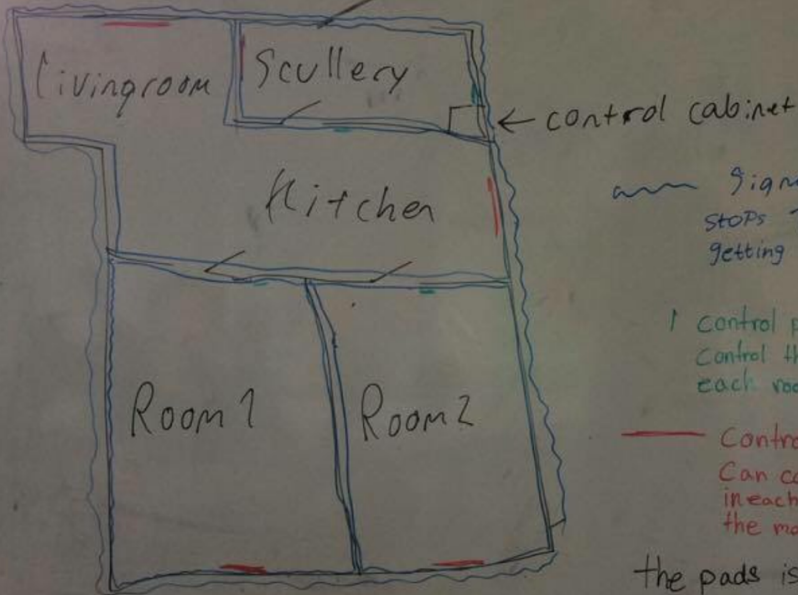

~ Signal blocker

| Control Pads

— Controllable radiators

← control cabinet

~ Signal blocker  
stops the signals from getting into the other rooms

| Control pads  
Control the electricity in each room with the app

— Controllable radiator  
Can control the temperature in each room on the app on the monitor

the pads is controlled using WiFi/Bluetooth