

Our capital city - Lisbon



Work done by:

- Beatriz Santos
- Tiago Pimenta

Lisbon – its location in the map



- Lisbon is the capital city of Portugal and it is the most populated city in the country with a population of about 530 000 people.



Lisbon



- It is considered a global city due to its importance in financial, commercial, media, artistic, educational and touristic aspects.
- It is also one of the richest regions in the country.

Lisbon



- It is considered a global city due to its importance in financial, commercial, media, artistic, educational and touristic aspects.
- It is also one of the richest regions in the country.

Lisbon

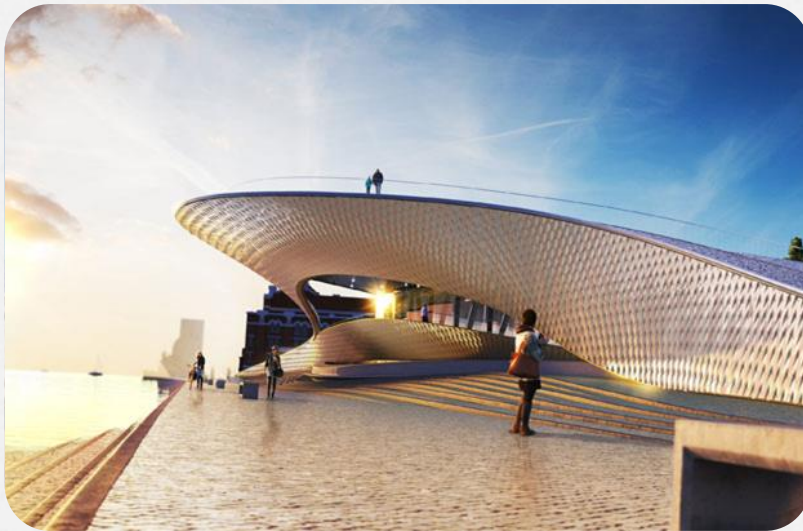

- It is considered a global city due to its importance in financial, commercial, media, artistic, educational and touristic aspects.
- It is also one of the richest regions in the country.

Lisbon



- Lisbon is a city with an intense cultural life.
- One of the most famous and most visited places in Portugal is Torre de Belém (built in the 16th century) - it is a very emblematic monument; Teatro Nacional D.Maria II in Rossio Square is also very famous and very symbolic.

Lisbon



- Lisbon is a city with an intense cultural life.
- One of the most famous and most visited places in Portugal is Torre de Belém (built in the 16th century) - it is a very emblematic monument; Teatro Nacional D. Maria II in Rossio Square is also very famous and very symbolic.

Lisbon



- Fado is the traditional music of Lisbon: it is a nostalgic type of music played with the typical guitar- Guitarra Portuguesa.
- It is famous all over the world and Amália Rodrigues is known by everybody for being the best fadista ever.

Lisbon



- Fado is the traditional music of Lisbon: it is a nostalgic type of music played with the typical guitar - Guitarra Portuguesa.
- It is famous all over the world and Amália Rodrigues is known by everybody for being the best fadista ever.

Visit Lisbon and you will have a fantastic experience!

